

BRAUNSTONE TOWN COUNCIL

OFFICER DECISION TAKEN UNDER DELEGATED POWERS

Improvements to Walking and Cycling Routes: Mossdale Meadows **3rd February 2023**

Background to the Decision

Leicester City Council, in partnership with Blaby District Council, secured funding from Leicester and Leicestershire Enterprise Partnership, Leicestershire Business Rates Pool and the Department for Transport to undertake a series of walking and cycling route improvements. Part of these improvements will provide enhanced connectivity between existing networks along the Great Central Way through to Braunstone Town and on to New Lubbethorpe. The routes will enable residents to access local facilities by non-motorised methods of transport.

On the 3rd November 2022, Policy & Resources Committee received an update on the delivery of proposals, approved the revised general arrangement for the Mossdale Meadows section of the scheme, subject to satisfactory resolution of the outstanding matters listed in the report; and gave delegated authority to approve the final designs and work schedules for Mossdale Meadows, including the arrangements and timescales (Policy & Resources Committee minute 60 2022/2023).

The Chief Executive & Town Clerk pursued the outstanding matters through the Partnership Project Meetings and reported to Policy & Resources Committee on 12th January 2023. Finalised plans and designs were being put together, including the lighting designs.

The Leader & Deputy Leader have been updated on progress at the Leaders' Meeting and the Leader of the Council was consulted on the final designs and plans on 2nd February 2023 and supported the proposals.

There are a number of miscellaneous matters to be considered and these are set out in the letter to Leicester City Council, which is attached at Appendix 1.

The designs, plans and schedules for the path, fencing and signage are set out at Appendix 2. The Lighting designs, plans and schedules are included at Appendix 3.

Authority for Decision

To find a balance between ensuring that the outstanding matters identified would be included in the approved designs and schedules, while avoiding delays to the timescales for the delivery of the works at Mossdale Meadows; Policy & Resources Committee on 12th January 2023 resolved "*that delegated authority be given to the Chief Executive & Town Clerk, in consultation with the Leader & Deputy Leader of the Council, to approve the final designs and work schedules for Mossdale Meadows and to determine the arrangements and timescales for the works to be undertaken at Mossdale Meadows*" (Policy & Resources Committee Minute 20 2022/2023).

Alternative Options Considered and Rejected

No alternative options were considered

Decision

1. That approval be given to Leicester City Council to undertake improvement works to the footpath at Mossdale Meadows between Kingsway and a new gateway to Meridian Leisure as part of a scheme to improve local pathways for walking and cycling; and
2. that the works be carried out in accordance with the submitted plans, as amended (Appendices 2 and 3), subject to the caveats set out in the approval letter (Appendix 1); and
3. that the works be carried out in accordance with the timescales and conditions set out in the approval letter (Appendix 1).

Approved By:



Darren Tilley

Date: 3rd February 2023

Reasons for Decision

1. The scheme would provide improvements for pedestrians and cyclists connecting facilities, amenities and communities across Braunstone Town, Meridian and Thorpe Astley.
2. To ensure that the agreed plans and arrangements were clearly set out; and that the pathway would be constructed to a high standard and would be fit for purpose.
3. To minimise disruption to users of Mossdale Meadows and to ensure that the Council's assets were protected and risks would be minimised.

List of Background Documents

None.

NOTE:

CRIME & DISORDER ACT 1998 (SECTION 17) – The Council has an obligation to consider Crime & Disorder implications of all its activities and to do all that it can to prevent Crime and Disorder in its area.

EQUALITIES ACT 2010

Braunstone Town Council has a duty in carrying out its functions to have due regard to:-

- eliminate unlawful discrimination, harassment and victimisation;
- advance equality of opportunity between different groups; and;
- foster good relations between different groups

To ensure that no person receives less favourable treatment on the basis of race, disability, sex, gender re-assignment, sexual orientation, age, religion or belief, marriage or civil partnership, pregnancy or maternity.

These issues were considered in connection with each of the above decisions. Unless otherwise stated under each item of this report, there were no implications.



BRAUNSTONE TOWN COUNCIL

Serving the communities of Braunstone Town and Thorpe Astley

Darren Tilley – Chief Executive & Town Clerk
 Braunstone Civic Centre, Kingsway, Braunstone Town, Leicester, LE3 2PP
 Telephone: 0116 2890045 Fax: 0116 2824785
 Email: enquiries@braunstonetowncouncil.org.uk

www.braunstonetowncouncil.org.uk

Our Ref:

Your Ref:

When calling please ask for:

Darren Tilley

Fraser Warwick
 Assistant Transport Development Officer
 Leicester City Council
 City Hall, 115 Charles Street
 Leicester
 LE1 1FZ

3rd February 2023

Dear Fraser,

RE: Proposed Improvement Works at Mossdale Meadows, Braunstone Town.

Further to your letter, received via email on 4th January 2023, including the associated plans and drawings, as updated on 1st February 2023, along with receipt of lighting designs, I write to approve your request to carry out works at Mossdale Meadows, Braunstone Town, as detailed in the plans (as amended, including lighting).

The works are approved strictly in accordance with the following submitted plans, as amended (attached); subject to the comments below:

1. General Arrangement: 0101/C02; subject to the lighting installation being carried out in accordance with the Lighting Design Drawing SL22-065A;
2. Fencing, Kerbs & Footways: 1101/C02; subject to the installation of permanent iron rail fencing adjacent to the play area either being the reinstatement of the existing fencing or any new fencing tying into and matching the existing;
3. Typical Cross Section: 1110/C01;
4. Traffic Signs and road markings: 1201/C02; subject to further consideration of caution signage around the depot; and realignment of disabled parking bays where the footpath ties into the existing car park;
5. Traffic Sign Schedules: 1210/C01; subject to further consideration of caution signage around the depot;
6. Geometry & Visibility Splays: 0121/C02;
7. Setting Out: 0122/C01;
8. Cross Sections: 0131/C02;
9. Long Section: 0141/C01;
10. Site Clearance & Earthworks: 0601/C02; subject to further consideration of whether the iron railing fence to the play area needs to be disposed or could be reused;

11. Outdoor Lighting Report: SL22-065, dated 23rd January 2023;
12. Lighting Design Drawing: SL22-065A;
13. Street Lighting Equipment Specification: received 1st February 2023; subject to further consideration of:
 - a) LAMP: "Dimming Levels to be controlled by Leicestershire County Councils Central Management System", and
 - b) PHOTOCELL: "with GPS for Leicestershire County Council";
14. Supply – 1L1-L1 Tails: received 1st February 2023;
15. Feeder Pillar disp board – 1L1-L1 Circuit 1: received 1st February 2023; and
16. Feeder Pillar disp board – 2L1-L1 Circuit 2: received 1st February 2023.

Leicester City Highways, and their appointed sub-contractors, are able to carry out the works detailed in the aforementioned documents commencing on 6th February 2023 for a period of up to 10 weeks. Should permission be required to extend the duration of the works beyond 14th April 2023, please request this in writing, at least 7 days in advance, setting out a proposed revised end date for the works.

Please liaise with Pauline Snow, Deputy Chief Executive & Community Services Manager, on 0116 289 9270 or pauline.snow@braunstonetowncouncil.org.uk concerning site arrangements, such as access, location of plant, pedestrian diversion routes etc.

Approval is granted on the following conditions:

1. confirmation of the Contractor's Public Liability Insurance;
2. public access being facilitated to the play area and sports courts at all times;
3. public footpath W5 remaining open for use at all times;
4. alterations and formal sign off of the works being submitted and approved by Braunstone Town Council; I would be grateful if you could advise on the process the City Council undertakes to inspect and sign off works, with a view to involving myself in this process both during and at the end of the works;
5. access being granted to a Braunstone Town Council approved contractor to install the CCTV cameras and associated equipment on the lighting columns as part of the works; and
6. the access through to Meridian Leisure not being opened for public use until the approved works in the submitted plans have been carried out, the lighting and CCTV has been installed and is operational; and completion has been approved and signed off by Braunstone Town Council.

I trust that this is sufficient for Leicester City Council Highways to carry out the works.

If you have any further queries, please do not hesitate to get in touch.

Yours sincerely,



Darren Tilley
Chief Executive & Town Clerk





VAT Reg No. 114762482



Notes - General Arrangement

1. The information shown on this drawing is intended to provide a general outline of the highway improvement works. Please refer to the detailed design drawings for specific scheme details.
2. Do not scale from this drawing. All dimensions must be checked/verified on site. If in doubt ask.
3. Any discrepancies noted on site are to be reported to the engineer immediately.
4. All works to be undertaken in accordance with Leicester City Council design standards, specifications and standard details.
5. This drawing is to be read in conjunction with all relevant architects, engineers and specialists drawings and specifications.

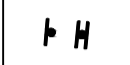
General Arrangement

-  Shared use footpath
-  Verges / embankments
-  Non illuminated traffic sign
-  Proposed 5m raise & lower lighting column with lantern to current Leicestershire County Council cyclepath specification [INDICATIVE ONLY]

Reproduced from Ordnance Survey Digital Data by permission of Ordnance Survey on behalf of the Controller of Her Majesty's Stationery Office. © Crown Copyright. All rights reserved. Reference number 100017603.

CONSTRUCTION ISSUE

SCHEDULE OF CHANGES (SINCE REV C01):

1. RADIUS TO THE SOUTH OF THE FOOTWAY CONNECTION TO WEST REMOVED.
2. EXTENTS OF EXISTING CONCRETE ROAD PAVEMENT TO BE REMOVED AND REPLACED AMENDED.
3. FENCING TO THE NORTH OF FOOTWAY AT BEND REDUCED IN LENGTH.

Rev.	Description	Date	Drn	CHK	App
C02	REFER TO SCHEDULE OF CHANGES	31.01.2023	GO	IF	IF
C01	CONSTRUCTION ISSUE	03.01.2023	GO	IF	IF

Issuing Office
Tetra Tech Leicester
 Executive Park, Avalon Way, Anstey, Leicester, United Kingdom, LE7 7GR
 Tel: +44 (0)11 6234 8000
 www.tetrateteurope.com



Client
LEICESTER CITY COUNCIL

Project Name
GREAT CENTRAL WAY - PHASE 2

Sheet Title
GENERAL ARRANGEMENT

TTE Project Number	Drawn By	Date	Checked By	Date	Approved By	Date	Scale @ A1	Suitability
784-B038444	GO	Jun '22	IF	July '22	IF	July '22	1:250	S4
Client Project Number	Originator	Volume/System	Level/Location	Type/Code	Role	Number	Revision	
B038444	TTE	- XX	- MM	- DR	- H	- 0101	C02	

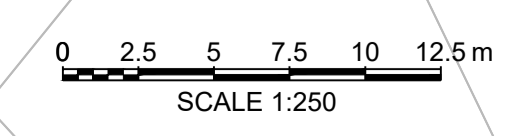
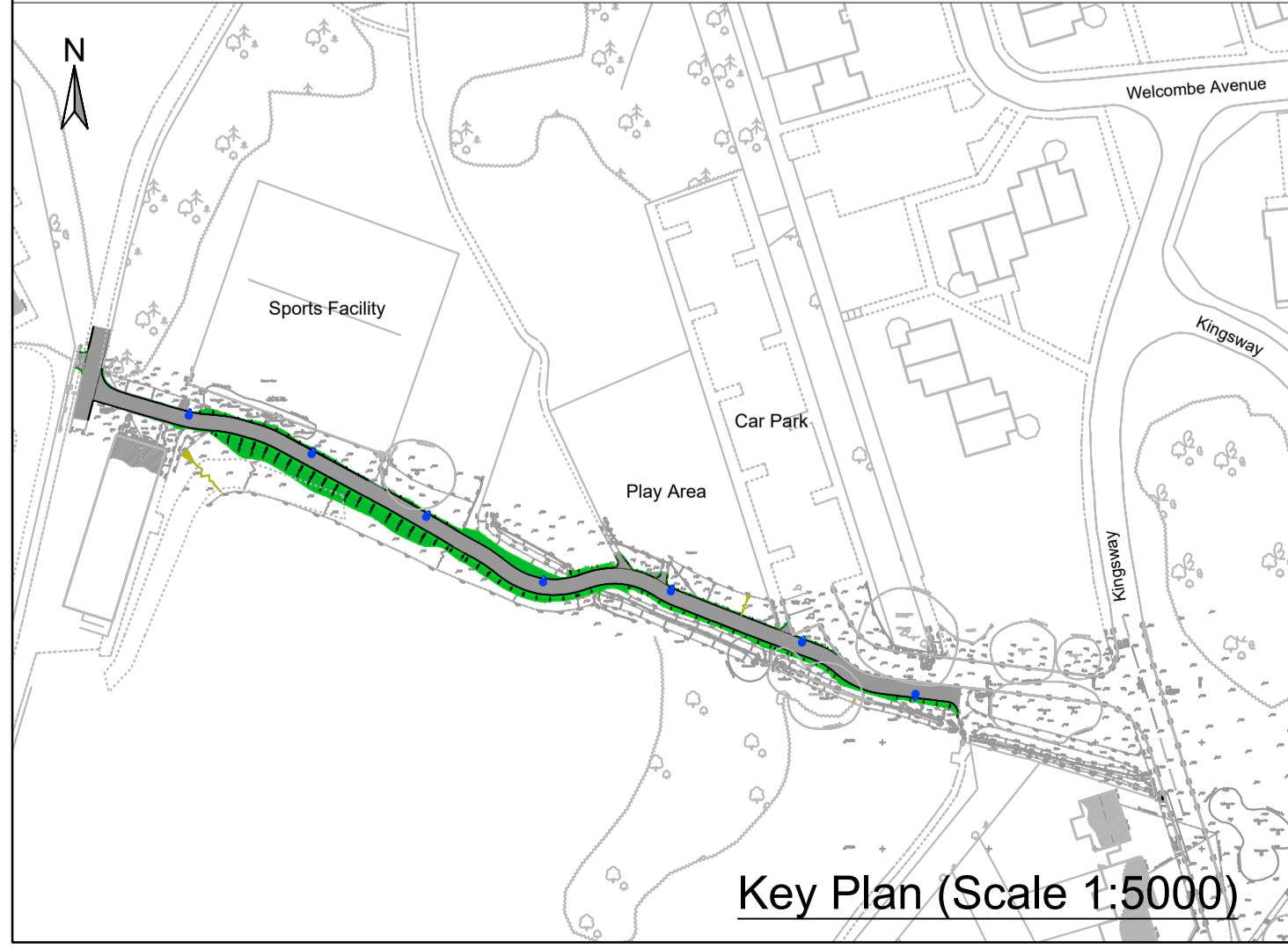
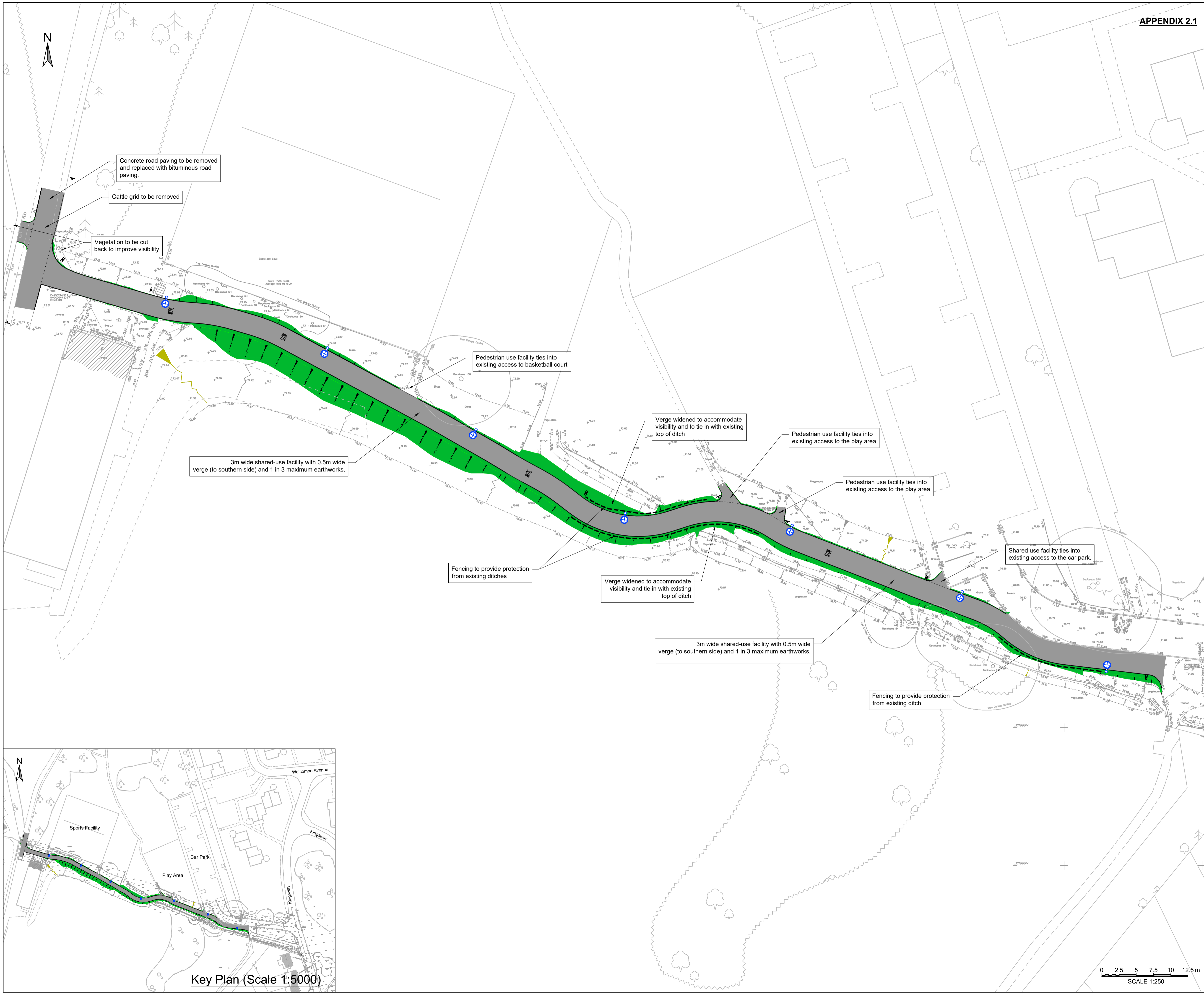

APPENDIX 2.2

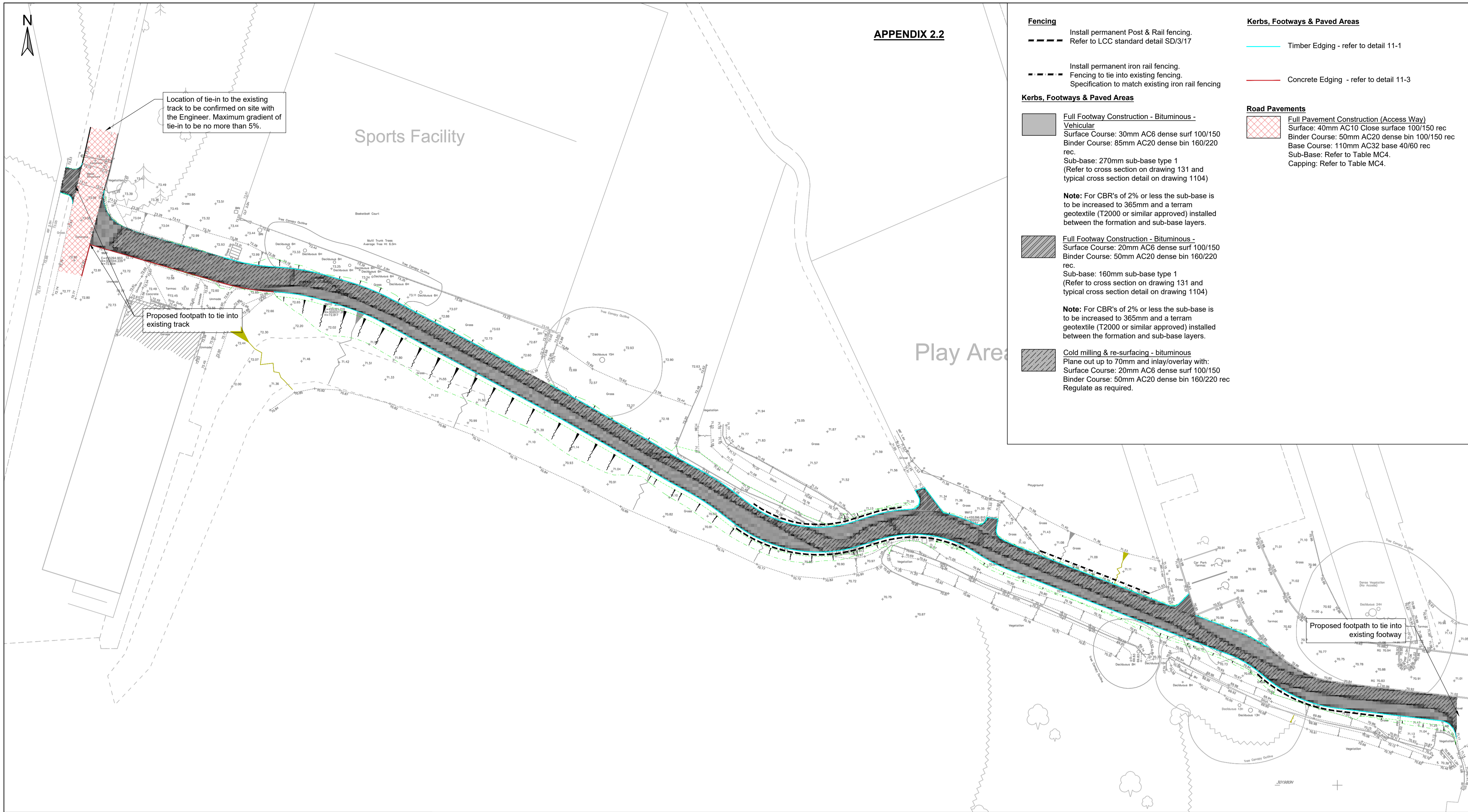

- Fencing**
- Install permanent Post & Rail fencing. Refer to LCC standard detail SD/3/17
 - Install permanent iron rail fencing. Fencing to tie into existing fencing. Specification to match existing iron rail fencing
- Kerbs, Footways & Paved Areas**
- Full Footway Construction - Bituminous - Vehicular**
Surface Course: 30mm AC6 dense surf 100/150
Binder Course: 85mm AC20 dense bin 160/220 rec.
Sub-base: 270mm sub-base type 1 (Refer to cross section on drawing 131 and typical cross section detail on drawing 1104)
Note: For CBR's of 2% or less the sub-base is to be increased to 365mm and a terram geotextile (T2000 or similar approved) installed between the formation and sub-base layers.
 - Full Footway Construction - Bituminous - Pedestrian**
Surface Course: 20mm AC6 dense surf 100/150
Binder Course: 50mm AC20 dense bin 160/220 rec.
Sub-base: 160mm sub-base type 1 (Refer to cross section on drawing 131 and typical cross section detail on drawing 1104)
Note: For CBR's of 2% or less the sub-base is to be increased to 365mm and a terram geotextile (T2000 or similar approved) installed between the formation and sub-base layers.
 - Cold milling & re-surfacing - bituminous**
Plane out up to 70mm and inlay/overlay with:
Surface Course: 20mm AC6 dense surf 100/150
Binder Course: 50mm AC20 dense bin 160/220 rec
Regulate as required.

- Kerbs, Footways & Paved Areas**
- Timber Edging - refer to detail 11-1
 - Concrete Edging - refer to detail 11-3
- Road Pavements**
- Full Pavement Construction (Access Way)**
Surface: 40mm AC10 Close surface 100/150 rec
Binder Course: 50mm AC20 dense bin 100/150 rec
Base Course: 110mm AC32 base 40/60 rec
Sub-Base: Refer to Table MC4.
Capping: Refer to Table MC4.

- Notes - Fencing**
- Fencing specification to be post and four rail fencing, with a top of rail height of 1.3m, as per LCC standard detail SD/3/17.
- Notes - Kerbs, footways and paved areas**
- Timber Edgings**
- Timber edgings are to be tanalised timber in accordance MCHW Clause 311.
 - Timber pegs to be at 1m centre and increased to 0.3m on radii's up to 12m.
 - At joints where two lengths of timber edging board meet a peg will be required and the joint formed by either using a mitre cut, using a bracing board (300mm in length) or a double peg to ensure that there is sufficient width to nail the board to the peg without splitting the timber.
 - Double staking to be used where there is a change in direction in the edging or on tight radii where shorter lengths of board are used.
- Footway & Cycleway**
- Anticipated footway category - Pedestrian/cycle/light vehicle
 - Where proposed footpath ties into existing footpath the construction is to be stepped. Refer to detail 11-2 on drawing.
 - A CBR value of more than 2% has been used for design purposes. The contractor shall verify actual CBR value on site through in-situ testing. The actual depth shall then be agreed with the Overseeing Organisation.
 - For typical cross sections refer to drawing B038444-TTE-XX-MM-DR-H-1110
- Notes - Drainage**
- All drainage to be 'over the edge drainage' as per existing arrangement. Proposed footpath crossfalls designed to fall as per existing topography.

Reproduced from Ordnance Survey Digital Data by permission of Ordnance Survey on behalf of the Controller of Her Majesty's Stationery Office. © Crown Copyright. All rights reserved. Reference number 100017603.

- SCHEDULE OF CHANGES (SINCE REV C01):**
- RADIUS TO THE SOUTH OF THE FOOTWAY CONNECTION TO WEST REMOVED.
 - EXTENTS OF EXISTING CONCRETE ROAD PAVEMENT TO BE REMOVED AND REPLACED AMENDED.
 - KERB DRAINAGE REMOVED FROM PROPOSAL.
 - FENCING TO THE NORTH OF FOOTWAY AT BEND REDUCED IN LENGTH

Table: MC4: Carriageway sub base and capping thickness

Minimum 450mm frost susceptibility (clause 4.68)

CBR Value	Access road (250mm bituminous layer)		Access way (200mm bituminous layer)		Industrial road (300mm bituminous layer)	
	Capping	Sub base	Capping	Sub base	Capping	Sub base
Less than 2%	550	200	500	250	600	150
2%	400	200	350	250	450	150
3%	300	200	250	250	350	150
4%	250	200	200	250	300	150
5 to 15%	200	200	200	250	250	150
More than 15%		200		250		150

(a) The foundation design should not vary frequently along the road. You should select an appropriate value for each significant change in the subgrade properties.

(b) Where the equilibrium CBR falls between values in the above table, you should round down the value to the lower value.

(c) When the subgrade CBR is sufficiently below 2% that capping with sub-base is not sufficient to support the pavement, special measures will be required. You can find advice in DMRB 7.2.2 HD25/94.

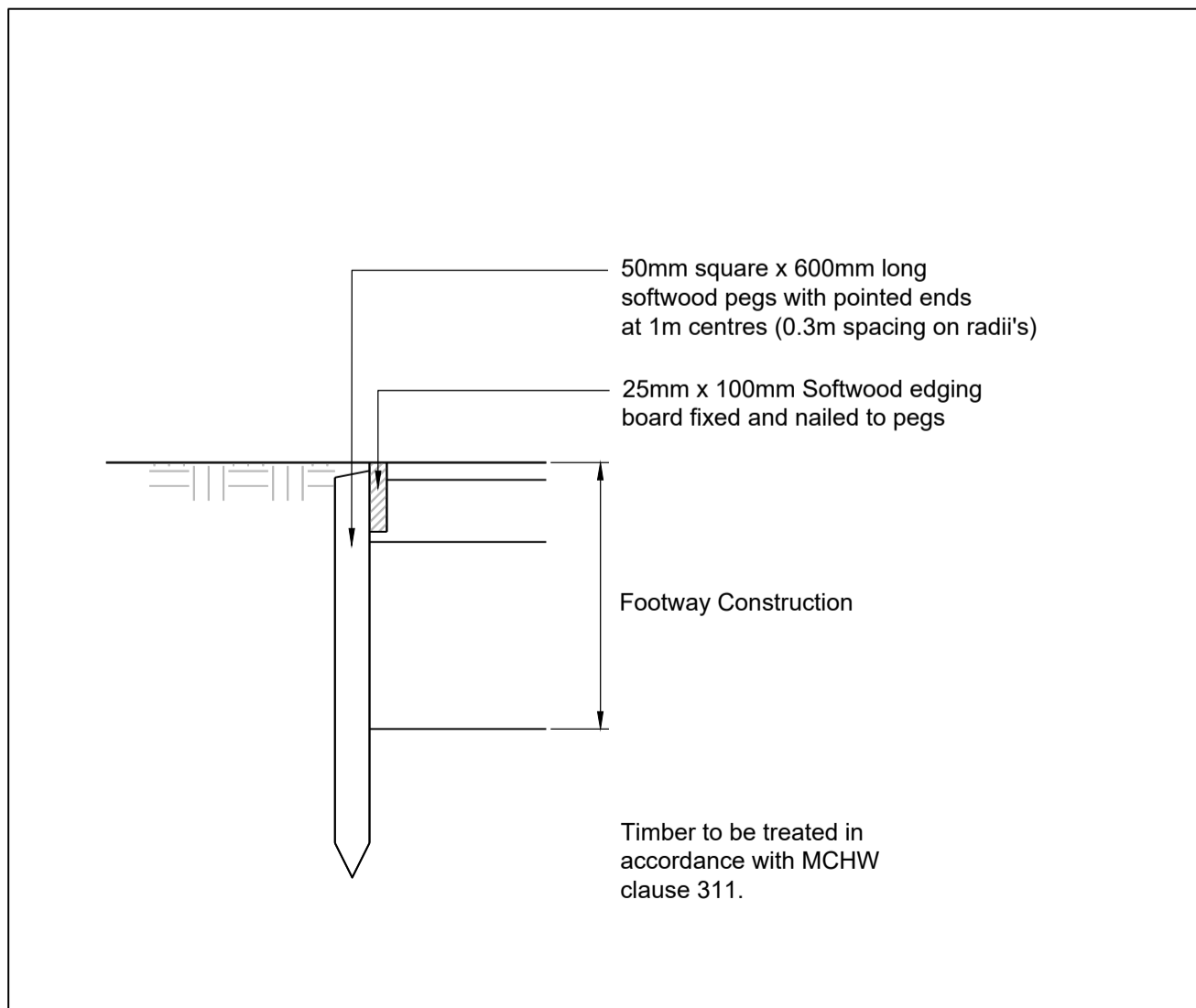

Detail 11-1
Timber Footway Edging (Scale: NTS)

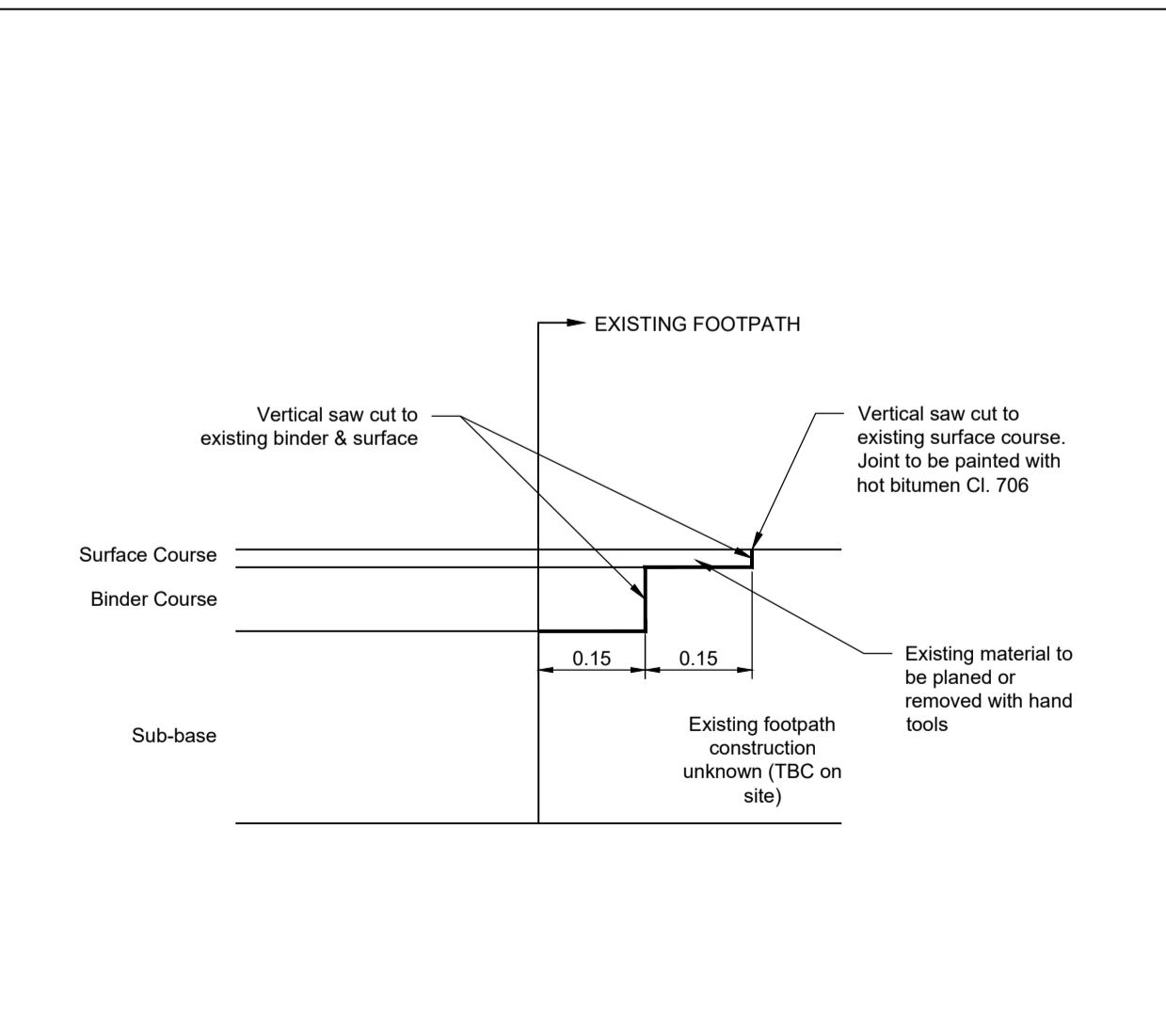

Details 11-2
Footpath Tie-in (Scale: NTS)

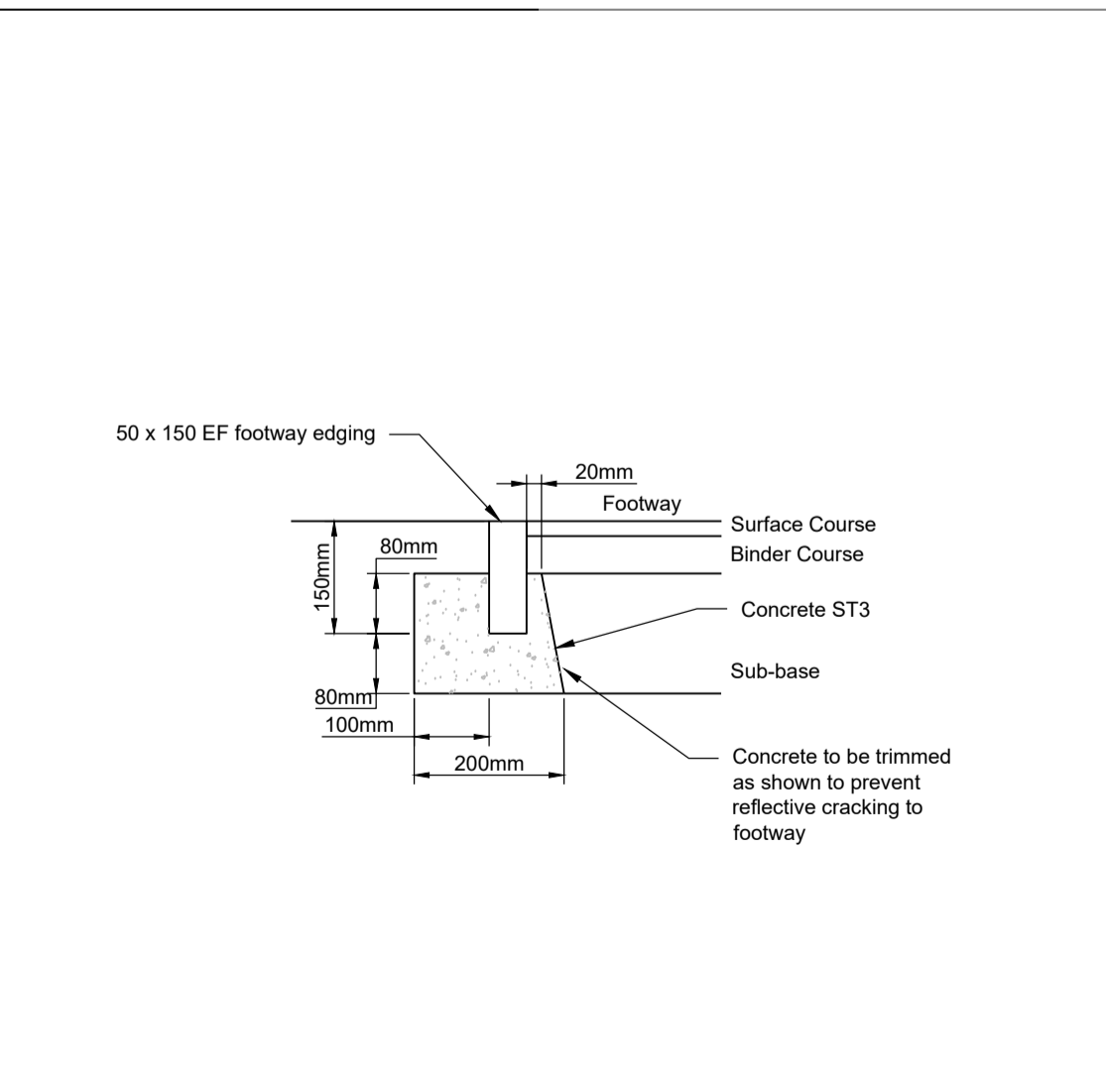

Detail 11-3
Kerbs - Footway Edging EF (Scale: NTS)

CONSTRUCTION ISSUE

Rev	Description	Date	GO	IF	IF
C02	REFER TO SCHEDULE OF CHANGES	31.01.2023	GO	IF	IF
C01	CONSTRUCTION ISSUE	03.01.2023	GO	IF	IF

Document Control

Issuing Office
Tetra Tech Leicester
 Executive Park, Avon Way, Anstey, Leicester, United Kingdom, LE7 7GR
 Tel: +44 (0)11 6234 8000
 www.tetratechleicester.com



Client
LEICESTER CITY COUNCIL

Project Name
GREAT CENTRAL WAY - PHASE 2

Sheet Title
FENCING, KERBS & FOOTWAYS

TTE Project Number	Drawn By	Date	Checked By	Date	Approved By	Date	Scale @ A1	Stability
784-B038444	GO	Jun '22	IF	Jun '22	IF	Jun '22	1:250	S4
Client Project Number	Originator	Volume/System Level/Location	Type/Code	Role	Number	Revision		
B038444	TTE	XX	MM	DR	H	1101	C02	

© Copyright Tetra Tech TTE_MF_v1

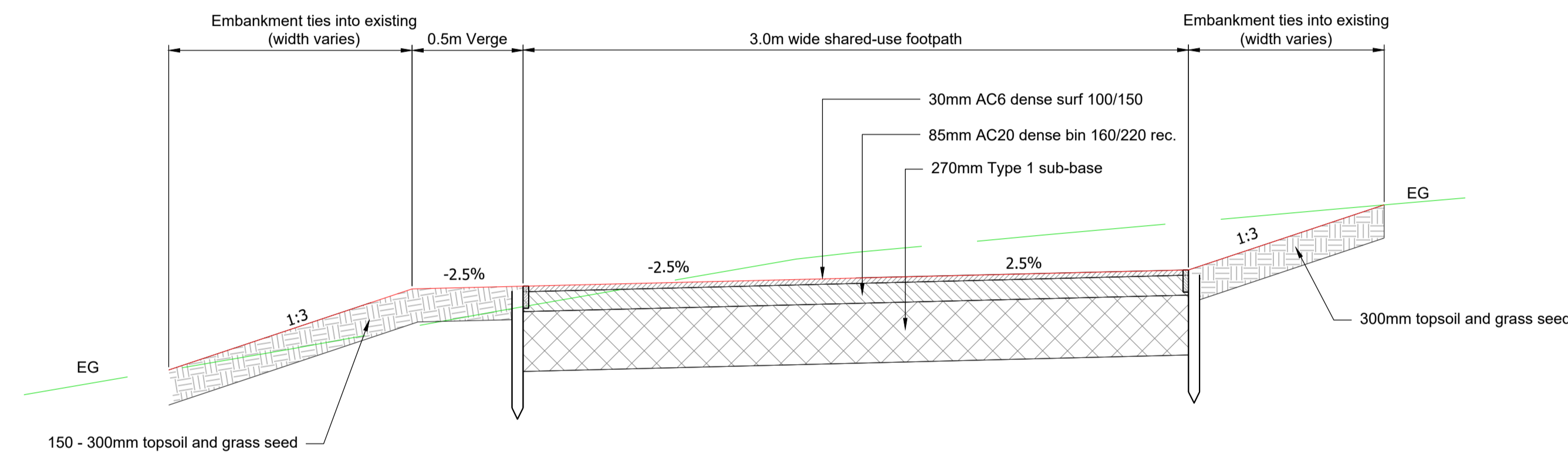

Typical section through existing footpath (Scale 1:20)

CONSTRUCTION ISSUE

Rev	Description	Date	Drn / Ck / App
C01	CONSTRUCTION ISSUE	03.01.2023	GO IF IF

Document Control

Issuing Office
Tetra Tech Leicester
 Executive Park, Avalon Way, Anstey,
 Leicester, United Kingdom, LE7 7GR
 Tel: +44 (0)11 6234 8000
 www.tetratecheurope.com



Client
LEICESTER CITY COUNCIL

Project Name
GREAT CENTRAL WAY - PHASE 2

Sheet Title
TYPICAL CROSS SECTION

TTE Project Number	Drawn By	Date	Checked By	Date	Approved By	Date	Scale @ A1	Suitability
784-B038444	GO	July '22	IF	July '22	IF	July '22	As Shown	S4

Client Project Number	Originator	Volume/System Level/Location	Type/Code	Role	Number	Revision
B038444	TTE	- XX	- MM	- DR	- H	- 1110 C01